

Cable Pair Colors  
 W White  
 G Green  
 O Orange  
 BL Blue  
 BR Brown

1	2	3	4	5	6	7	8
W-G	G	W-O	BL	W-BL	O	W-BR	BR
Designation T568A 8-Position jack pin/pair assignments							
1	2	3	4	5	6	7	8
W-O	O	W-G	BL	W-BL	G	W-BR	BR
Designation T568B 8-Position jack pin/pair assignments							

568B Wiring Example

1



- Slide the strain relief boot onto the cable
- Secure with removable tape(Optional)

2



- Trim the cable jacket back about 1.5"
- Carefully trim any foil shielding
- Cut the center spline, if needed

3

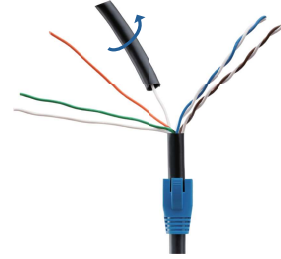

- Straighten each twisted wire with the clipped cable jacket and move them to the side in pairs

4

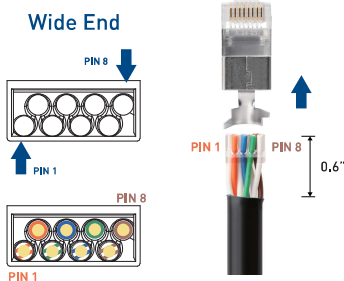

- Insert the wires into the load bar's wide end
- Cut the excess wires along the narrow edge of the load bar
- Orient the load bar to mate with the plug, narrow end will be inserted first

5



- Insert the load bar and wires into the plug
- Check that the cable jacket fits into the plug housing
- Attach the metal clip to the cable

6



- Place cable into the crimper tool for metal clip clamping
- Do not damage the cable jacket

7



- Use a crimp tool with a removable punch die so the housing is not pierced
- Firmly crimp the connector

8

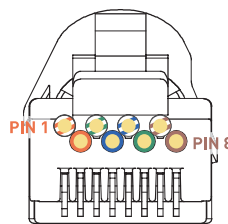

- Visually check that the wires are fully inserted, and the wires are not touching each other

9



- Pull the strain relief boot over the connector
- Note: Example is 568B wiring

Specifications

- **Connectors:** RJ45 Plugs
- **Rating:** Cat 8
- **Compatibility:** Insulation diameter of single wire is 1.35-1.45mm, 21-23 AWG solid or stranded STP/FTP/UTP cable, maximum diameter of the outer protective sleeve is 8mm
- **Warranty:** Limited Lifetime

Suggested Tools

- Crimp tool for shielded RJ45 plugs with a removable die (SKU: 180124)
- Wire cutter (regular and flush)
- Cable stripping tool
- Needle nose pliers